

# NOWTHEN STUDIOS

---

## **Rebuild Update:** New Facilities Plan

Warehouse Functional Floor Plan & Interior Design

### **Contents:**

1. Cover Page
2. Concept Design
3. Floor Plan: in Zones
4. Floor Plan: Dimensioned
5. - 15. 3D Images
  5. Reception
  6. Donor Wall
  7. Conference Room
  8. Front Entrance
  9. Office & Break Room
  10. Break Room
  11. Office #2
  12. Warehouse: View from Office
  13. Warehouse: View from Back
  14. Warehouse: View to Donation Counter
  15. Warehouse: View to Shelves

### **Company Contact**

Melody Wunrow  
864-334-8348  
[melody@nowthenstudios.com](mailto:melody@nowthenstudios.com)



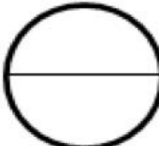

Functional Floor Plan: Concept

Scale: 1/16" = 1'

Designed by Melody Wunrow July 2024

Nowthen Studios LLC Copyright 2024



Rebuild Upstate - Easley, SC  
New Facility Plan

Versions

July 15, 2024	Version 1: Issued to LGM Architects
July 30, 2024	Version 2: Issued to LGM Architects & Rebuild Upstate



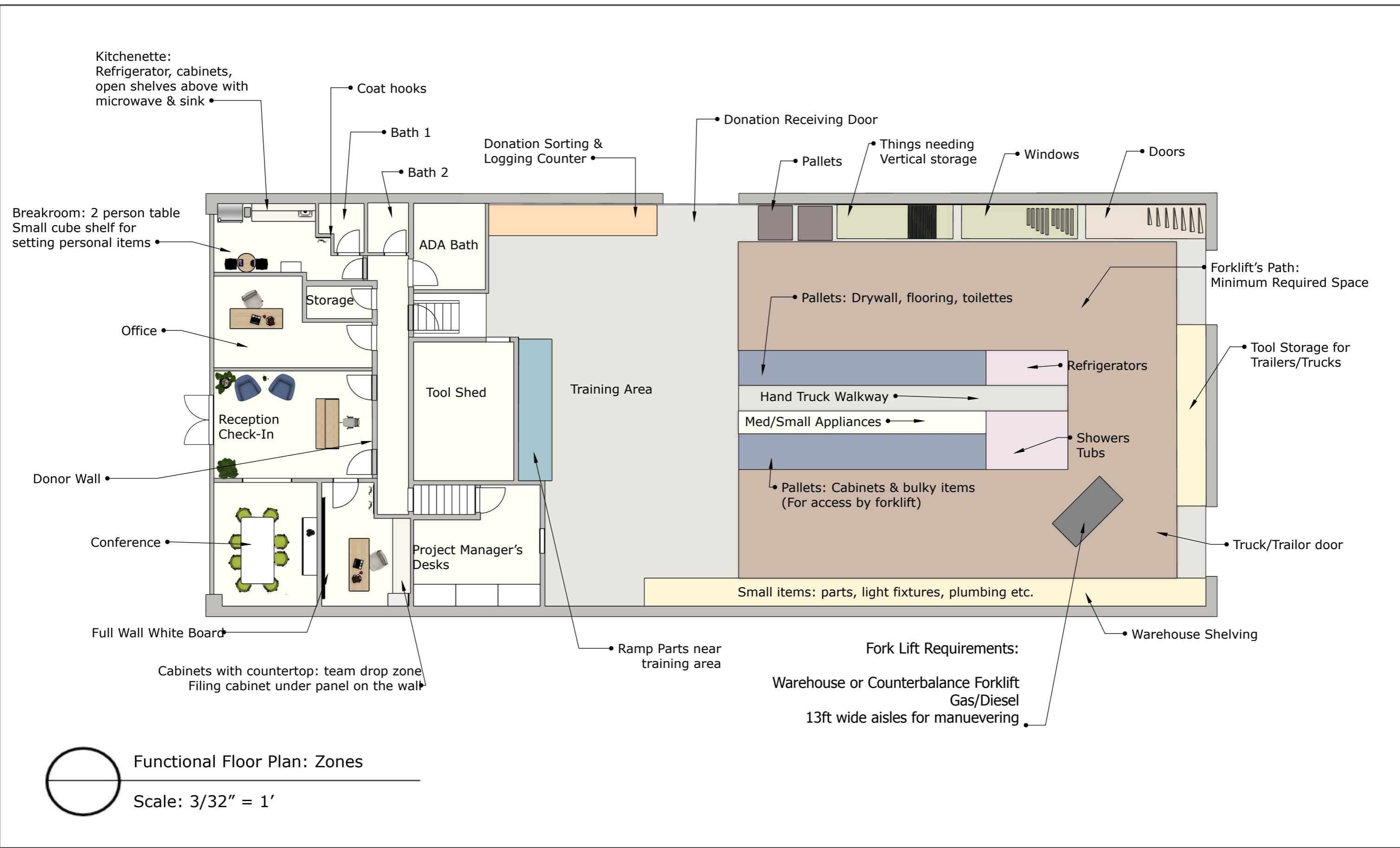

Designed by Melody Wunrow July 2024

Nowthen Studios LLC Copyright 2024



NOWTHEN STUDIOS

Rebuild Upstate - Easley, SC  
New Facility Plan

Versions

July 15, 2024	Version 1: Issued to LGM Architects
July 30, 2024	Version 2: Issued to LGM Architects & Rebuild Upstate

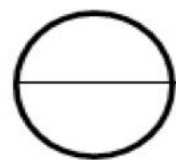
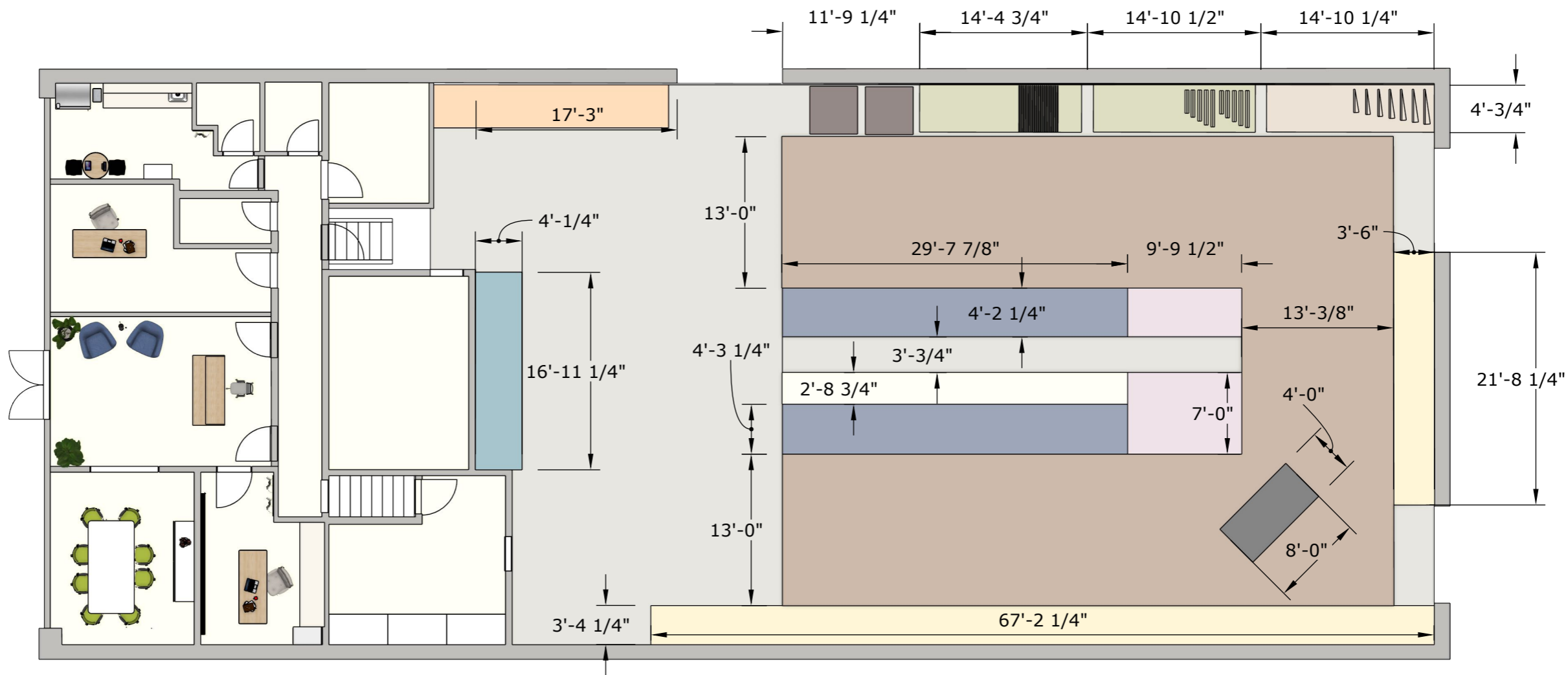

Functional Floor Plan: Space Planning

Scale: 3/32" = 1'

Designed by Melody Wunrow July 2024

Nowthen Studios LLC Copyright 2024



NOWTHEN STUDIOS

Rebuild Upstate - Easley, SC  
New Facility Plan

Versions

July 15, 2024	Version 1: Issued to LGM Architects
July 30, 2024	Version 2: Issued to LGM Architects & Rebuild Upstate



Framed Photos of Rebuild's  
Team, clients, projects,  
Or significant events

Use throughout the office  
Spaces: reception, conference,  
break room, and 2 main offices

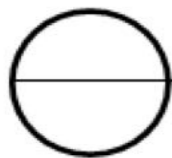

Functional Floor Plan: Reception

3D Model

Designed by Melody Wunrow July 2024

Nowthen Studios LLC Copyright 2024



NOWTHEN STUDIOS

Rebuild Upstate - Easley, SC  
New Facility Plan

Versions

July 15, 2024	Version 1: Issued to LGM Architects
July 30, 2024	Version 2: Issued to LGM Architects & Rebuild Upstate



Logo in the center with brick around

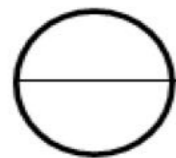
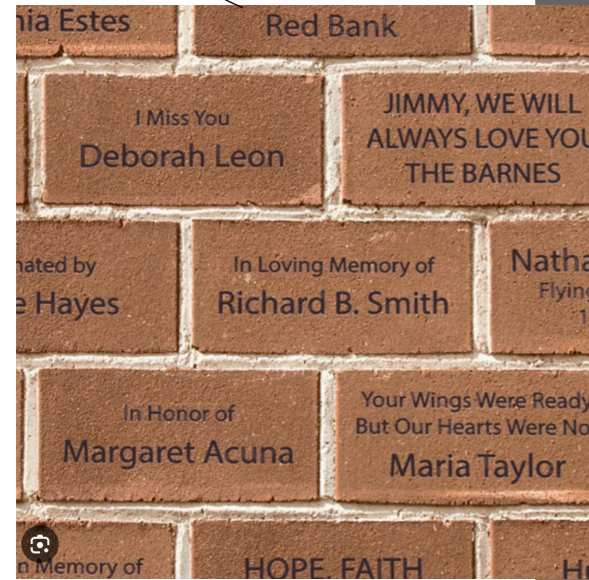

Functional Floor Plan: Donor & Logo Wall

3D Model

Focal Point: Logo & Donor Wall centered behind reception desk used for personnel check-in

Donor plaques made out of engraved, painted, or decaled red brick  
 Small sitting area, a couple of fake plants And photos of Rebuild's impact, team, clients, or significant events on the walls

Designed by Melody Wunrow July 2024

Nowthen Studios LLC Copyright 2024



Rebuild Upstate - Easley, SC  
 New Facility Plan

Versions

July 15, 2024	Version 1: Issued to LGM Architects
July 30, 2024	Version 2: Issued to LGM Architects & Rebuild Upstate



Additional Donor Wall  
If needed

Sideboard Cabinet for  
drinks & snacks, promo  
materials, notebooks

Photo of Rebuild's Impact

TV for Presentations

**Use Green, Blue, &  
White Color Scheme  
throughout all office  
spaces (when able) to  
create brand continuity**

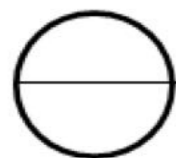

Functional Floor Plan: Conference

3D Model

Designed by Melody Wunrow July 2024

Nowthen Studios LLC Copyright 2024



Rebuild Upstate - Easley, SC  
New Facility Plan

Versions

July 15, 2024	Version 1: Issued to LGM Architects
July 30, 2024	Version 2: Issued to LGM Architects & Rebuild Upstate



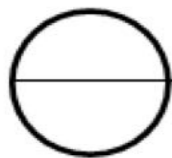

Functional Floor Plan: Front Entrance

3D Model

Designed by Melody Wunrow July 2024

Nowthen Studios LLC Copyright 2024



NOWTHEN STUDIOS

Rebuild Upstate - Easley, SC  
New Facility Plan

Versions

July 15, 2024	Version 1: Issued to LGM Architects
July 30, 2024	Version 2: Issued to LGM Architects & Rebuild Upstate



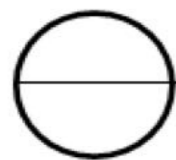

Functional Floor Plan: Break Room & Office

3D Model

**Break Room:**

Row of cabinets with frig & sink, microwave & shelves above, & bistro table & chairs

**Office:** Simple desk setup

**Both rooms:** Accent painted wall in Rebuild's brand colors, and framed photos of projects/clients/the team at work

Designed by Melody Wunrow July 2024

Nowthen Studios LLC Copyright 2024



NOWTHEN STUDIOS

Rebuild Upstate - Easley, SC  
New Facility Plan

**Versions**

July 15, 2024	Version 1: Issued to LGM Architects
July 30, 2024	Version 2: Issued to LGM Architects & Rebuild Upstate

Break Room:  
 Row of cabinets with frig & sink, microwave & shelves above, & bistro table & chairs

Employee storage: Place hooks on the wall in the nook as you enter (not shown in this view) and a cube shelf next to the table for setting personal items, lunch boxes, etc. on.

**NOTE:** Now that you have this space - providing a better place to have volunteer training events and host donors - you may find that you host events more often at the warehouse. In this scenario, you may need more storage in the break room for meals/serving and maybe small amounts of table decor, that you want to have on hand for these potential events.

So, another option is to go ahead and put wall cabinets in the break room rather than the open shelves so that you have the additional storage capacity to accommodate items you may need for these donor or training events.

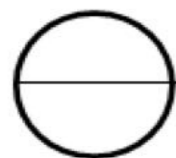

Functional Floor Plan: Break Room & Office

3D Model

Designed by Melody Wunrow July 2024

Nowthen Studios LLC Copyright 2024



NOWTHEN STUDIOS

Rebuild Upstate - Easley, SC  
 New Facility Plan

Versions

July 15, 2024	Version 1: Issued to LGM Architects
July 30, 2024	Version 2: Issued to LGM Architects & Rebuild Upstate



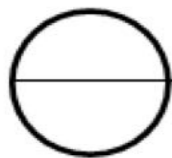

Functional Floor Plan: 2nd Office

3D Model

Office: Desk, full wall white board (not shown), row of cabinets or simply a table/countertop for team drop zone  
 Wall hooks for coats, filing cabinet, and company art with company colors.

Designed by Melody Wunrow July 2024

Nowthen Studios LLC Copyright 2024



NOWTHEN STUDIOS

Rebuild Upstate - Easley, SC  
 New Facility Plan

Versions

July 15, 2024	Version 1: Issued to LGM Architects
July 30, 2024	Version 2: Issued to LGM Architects & Rebuild Upstate



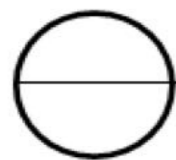

Functional Floor Plan: Warehouse

3D Model: View towards garage doors

Left: Wall used for items needing vertical storage. Doors, windows, empty pallets, etc.  
 Center left: Pallets for drywall, tile, LVP, sinks, toilettes, and refrigerators at the end.  
 Center: Hand truck walkway to the left of an isle for small appliances- washer, dryer, stoves, water heaters  
 Center right: Pallets for cabinetry, with tubs & showers at the end  
 Right wall: Floor to ceiling warehouse shelving for boxed items, small parts, lighting, plumbing fixtures etc.  
 Back wall between doors: tool storage/work bench for tools used with trucks/trailers on the regular basis.

Designed by Melody Wunrow July 2024

Nowthen Studios LLC Copyright 2024



NOWTHEN STUDIOS

Rebuild Upstate - Easley, SC  
 New Facility Plan

Versions

July 15, 2024	Version 1: Issued to LGM Architects
July 30, 2024	Version 2: Issued to LGM Architects & Rebuild Upstate



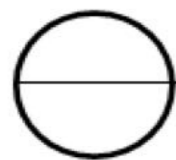

Functional Floor Plan: Warehouse

3D Model: View towards offices

View towards the office spaces:  
 13' aisle for forklift, pallets & appliances in the center, shelving on the left, training center in the back nearest the offices & tool storage room, and doors, windows, and other vertical items on the right. Will need vertical dividers not the right for doors & windows to lean against.

Designed by Melody Wunrow July 2024

Nowthen Studios LLC Copyright 2024



**NOWTHEN STUDIOS**

Rebuild Upstate - Easley, SC  
 New Facility Plan

**Versions**

July 15, 2024	Version 1: Issued to LGM Architects
July 30, 2024	Version 2: Issued to LGM Architects & Rebuild Upstate



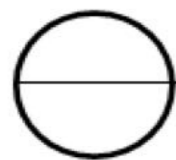

Functional Floor Plan: Warehouse

3D Model: View towards donation counter

Left: Training area and donation receiving area in the back by the donation garage door & office entrances

Center: Pallets with cabinetry, appliances, sinks, flooring, drywall

Back wall: empty pallets, vertical storage, windows, & doors

Right: tool storage area for trucks

Designed by Melody Wunrow July 2024

Nowthen Studios LLC Copyright 2024



NOWTHEN STUDIOS

Rebuild Upstate - Easley, SC  
New Facility Plan

Versions

July 15, 2024	Version 1: Issued to LGM Architects
July 30, 2024	Version 2: Issued to LGM Architects & Rebuild Upstate

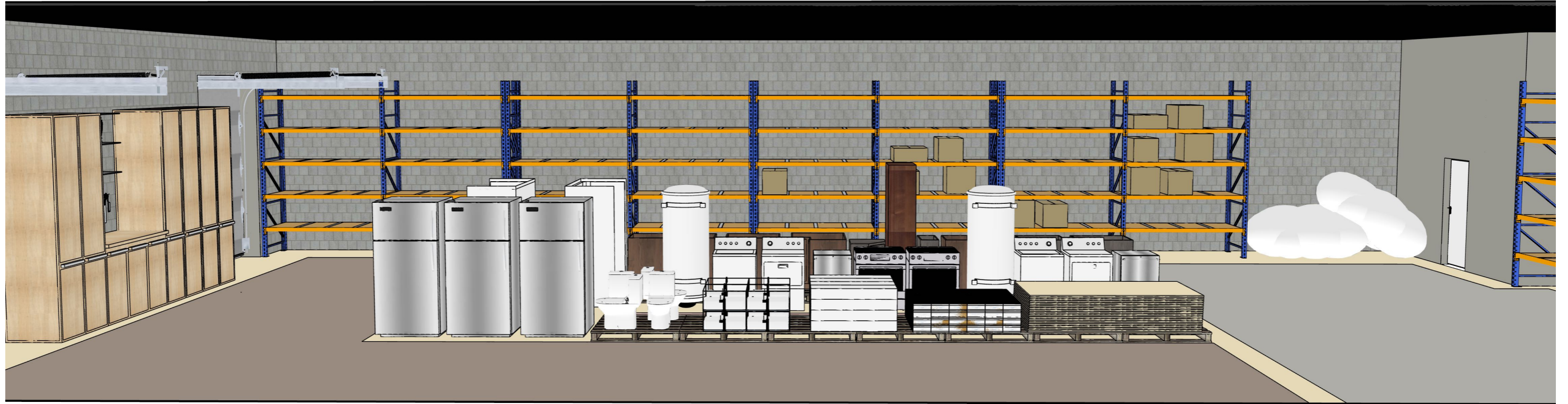

Left: locking tool storage cabinets for the trucks  
 Center: pallets with heavy items & appliances  
 Back wall: warehouse shelving for small parts, boxes, plumbing fixtures, lighting, etc.  
 Right: existing shelving near training area & tool storage room  
 Back right corner: door into Project Manager's office

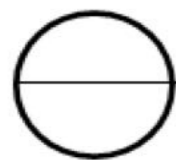

Functional Floor Plan: Warehouse

3D Model: View towards shelving

Designed by Melody Wunrow July 2024

Nowthen Studios LLC Copyright 2024



NOWTHEN STUDIOS

Rebuild Upstate - Easley, SC  
New Facility Plan

Versions

July 15, 2024	Version 1: Issued to LGM Architects
July 30, 2024	Version 2: Issued to LGM Architects & Rebuild Upstate